

Spring plunger

Smooth design, standard spring force

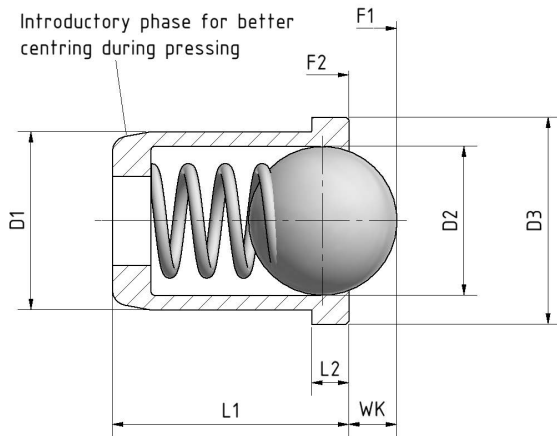

Art. No. Ball Stainless steel	Art. No. Ball POM	D1 +0.1	D2 Ball Ø	D3	WK	L1	L2	Spring force Start F1 ≈ N	Spring force End F2 ≈ N
1-28-2003	1-28-4003	3	2.5	3.5	0.7	4	0.6	1.7	3.6
1-28-2004	1-28-4004	4	3	4.6	0.7	5	1	3	7
1-28-2005	1-28-4005	5	4	5.6	1	6	1	4	7
1-28-2006	1-28-4006	6	5	6.5	1.5	7	1	6	12
1-28-2008	1-28-4008	8	6.5	8.5	1.8	9	1	6	12
1-28-2010	1-28-4010	10	8	11	3	13.5	1.9	10	20
1-28-2012	1-28-4012	12	10	14	3.5	16	2.5	13	25

All data in mm. Standard version ex stock. Other dimensions and materials are also possible on request.
We reserve the right to make design changes for technical/manufacturing reasons.

Material · Technical data

Housing	Stainless steel
Ball	Hardened stainless steel or POM (Thermoplastic)
Spring	Stainless steel, reinforced version also possible

